

# ADE OY

Finnish tech company from Turku, founded in 2000

- ▶ Focus on comprehensive virtual education solutions, highlighting virtual simulations
- ▶ Solutions delivered as ensemble, including ready-made training content and necessary software, devices and equipment

Experienced production team with 14 members assure premium quality

- ▶ Tens of virtual reality education courses tailored for customers
- ▶ Products Virtual training center, Webink web to print, WebLink sales configurator



# VIRTUAL TRAINING CENTER

A cloud based training and simulation environment with ready-made virtual reality courses



[https://www.youtube.com/watch?v=UYKd\\_YIbWUg&feature=youtu.be](https://www.youtube.com/watch?v=UYKd_YIbWUg&feature=youtu.be)



# SOLVING THE PROBLEM OF LIMITED RESOURCES

10 billion euros used into private education annually in Finland

- ▶ Expenses for the organizer of the education, approximately 40,4%
- ▶ Travel expense allowances of attendees, approximately 7,9%
- ▶ Other expenses such as materials and educators' salaries, approximately 6,3%



Virtual Training Center makes it possible to reduce the education costs significantly

# COMPLETELY NEW APPROACH

Compiling all training content into one cloud platform enabling training regardless of the time or location

- ▶ Train wherever you like, whenever you like in virtual reality environment
- ▶ No need for adapting schedules or traditional simulation device

Link to platform video: <https://www.youtube.com/watch?v=OlptBCcbh08&feature=youtu.be>



# COMPREHENSIVE TRAINING FOR ANY INDUSTRY

E-learning and simulation easily and effectively in the same environment

- ▶ Extensive cloud library of qualified e-learning and simulation content tailored for different industries
- ▶ Learning management system that enables monitoring and managing the training
- ▶ Easy to use for both the trainee and the educator due to intuitive 3D environment

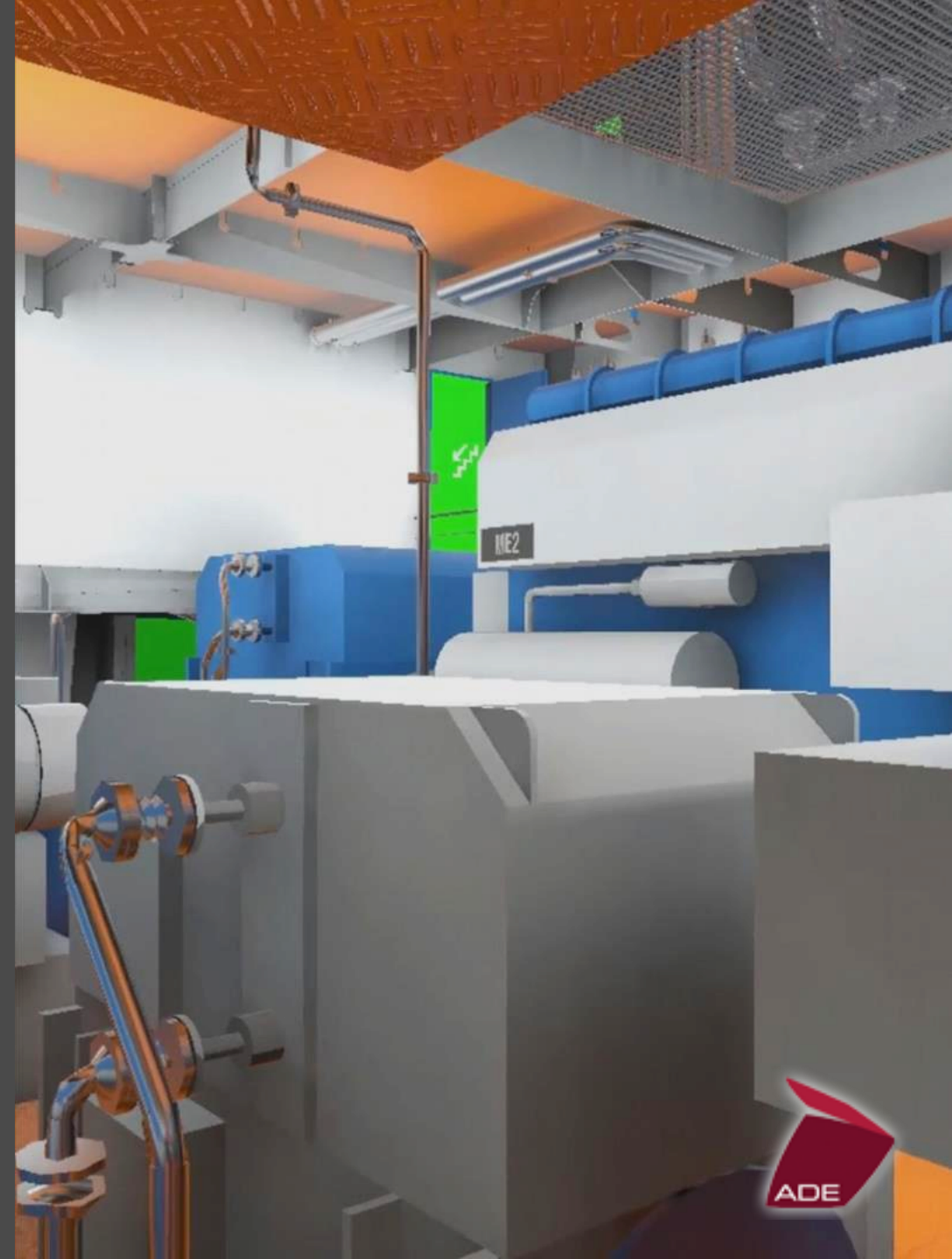

# EASY TO ACCESS WHEREVER NEEDED

- ▶ The system includes a wide selection of qualified training content and all of the necessary software, devices and equipment
- ▶ The environment can be integrated to private and national education systems and tailored to any local operational environment by ADE or a local operator



# NETWORK BEHIND THE PROJECT



- ▶ Kiwa Inspecta, partner in education and certification

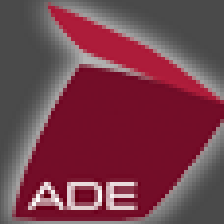

- ▶ ADESANTE, partner in healthcare education

**TURKU AMK**   
TURKU UNIVERSITY OF APPLIED SCIENCES

- ▶ TUAS, partner in R&D and education



# Surgery vision

---

Surgery Vision is a Virtual Reality solution in use in university hospitals presenting patients MRI and / or CT images as a virtual model. It uses Ai for example to highlight tumors. It is a CE class 1 medical devise.

- <https://vimeo.com/263546568>





# CASE Simulandia (TTS)

Simulandia is a virtual reality simulation training center including 15 different simulators for driving cars and trucks and training social interactions in virtual reality.

<https://drive.google.com/file/d/1hwdv0k9UJecPtgIXLc5pWWuHeAR-0AV6/view>



# Wärtsilä engine room training

---

The user trains to read engine blueprints in virtual reality. Whole engines are presented in virtual reality and moving and part locations are trained.

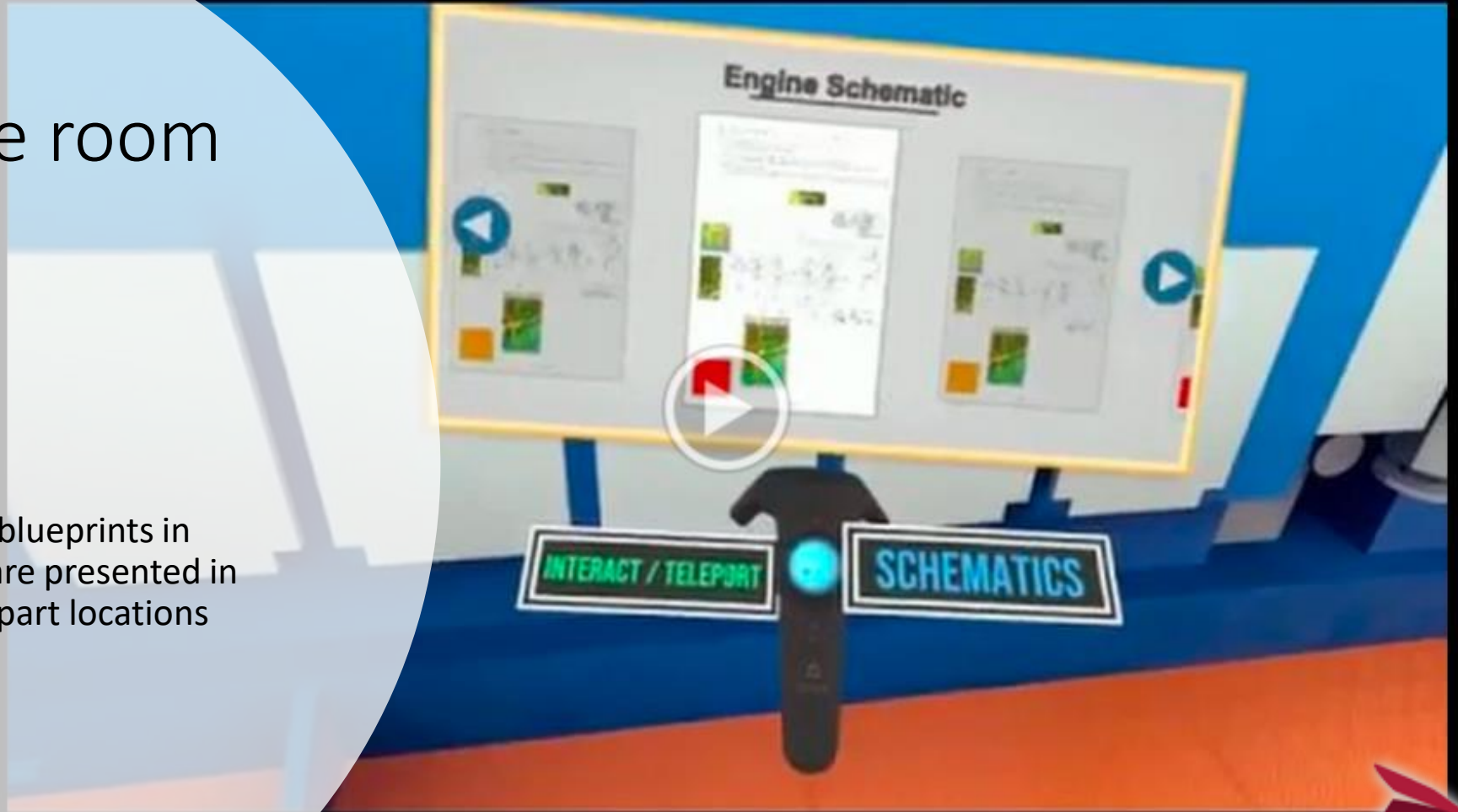

# Logistics work safety training (AEL)

The virtual reality logistics center trains the user of the safety risks. The user is also trained to correctly package and transport materials in the area.

The virtual reality environment won the Finnish national agency for education (OPH) award for the most innovative training method.

